

# SPACE PLANS

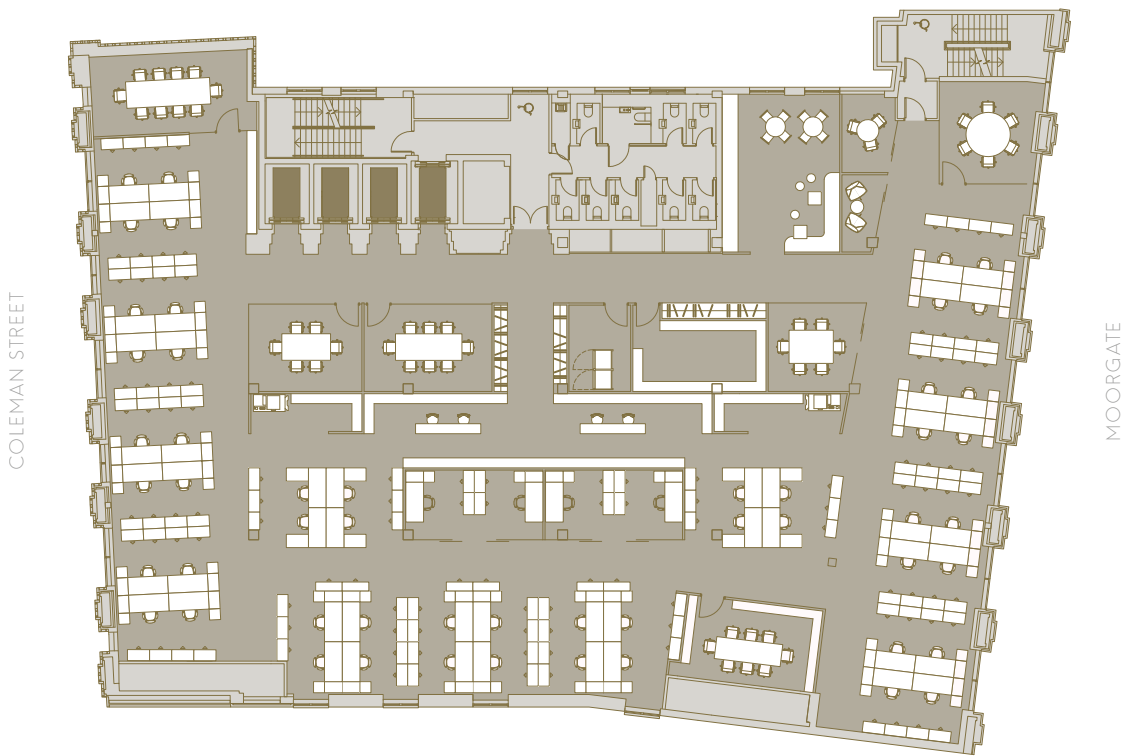

## LEGAL – MULTI TENANTS

2x office	4	6x meeting room	3	Total workplaces:	56
Legal studio workstation	44	8x meeting room	1	Meeting rooms seats:	49
Admin/assistant	8	10x meeting room	1	<b>Planning ratio:</b>	
2x conf call room	1	8x case room	1	<b>1 person: 187 sq ft (17.4 m<sup>2</sup>)</b>	
3x conf call room	1				



Floor plans not to scale, for indicative purposes only.  
For typical floor plates, visit the website: [www.77coleman.com](http://www.77coleman.com)

# SPACE PLANS



## OPEN PLAN - SINGLE FLOOR TENANT

Open plan workstation	72	20x meeting room	3	Total workplaces:	74
Receptionist	2	2x quiet room	1	Meeting rooms seats:	49
4x meeting room	8	3x quiet room	1	<b>Planning ratio:</b>	
8x meeting room	1	4x quiet room	1	<b>1 person: 142 sq ft (13.2 m<sup>2</sup>)</b>	

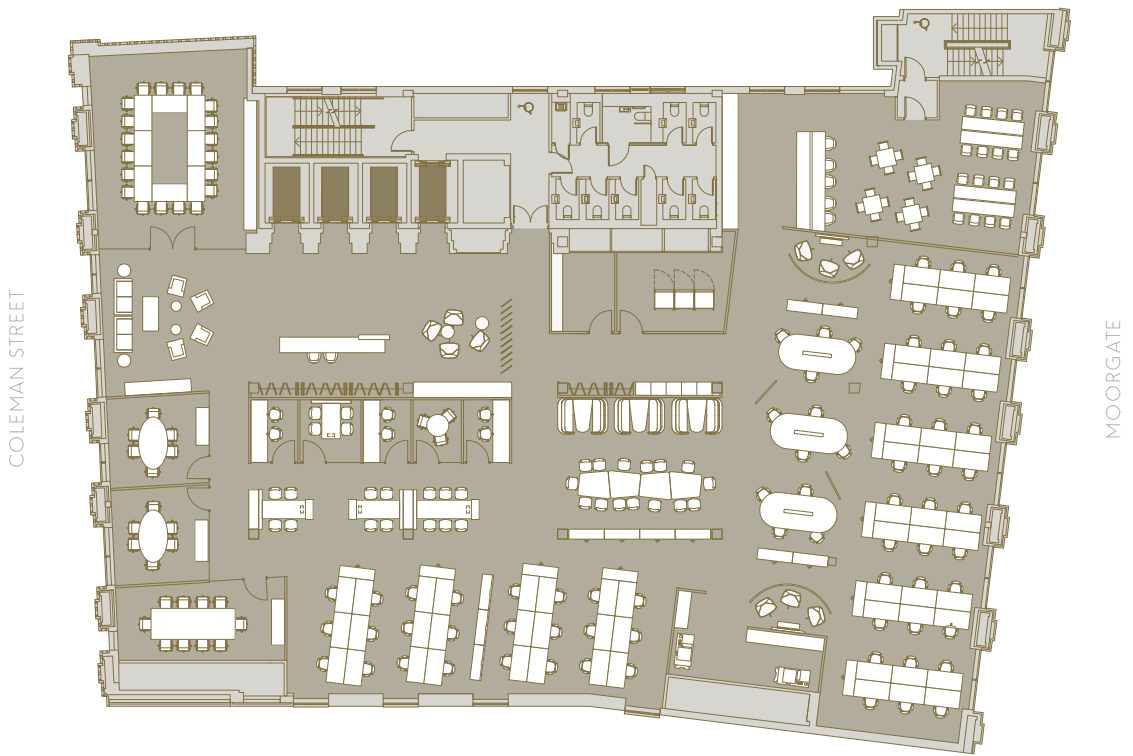

Floor plans not to scale, for indicative purposes only.  
For typical floor plates, visit the website: [www.77coleman.com](http://www.77coleman.com)

# SPACE PLANS



## OPEN PLAN - MULTI FLOOR TENANTS

Open plan workstation	102
4x meeting room	8
8x meeting room	2

1x quiet room	3
2x quiet room	1

Total workplaces:	102
Meeting rooms seats:	25

**Planning ratio:**  
**1 person: 103 sq ft (9.6 m<sup>2</sup>)**

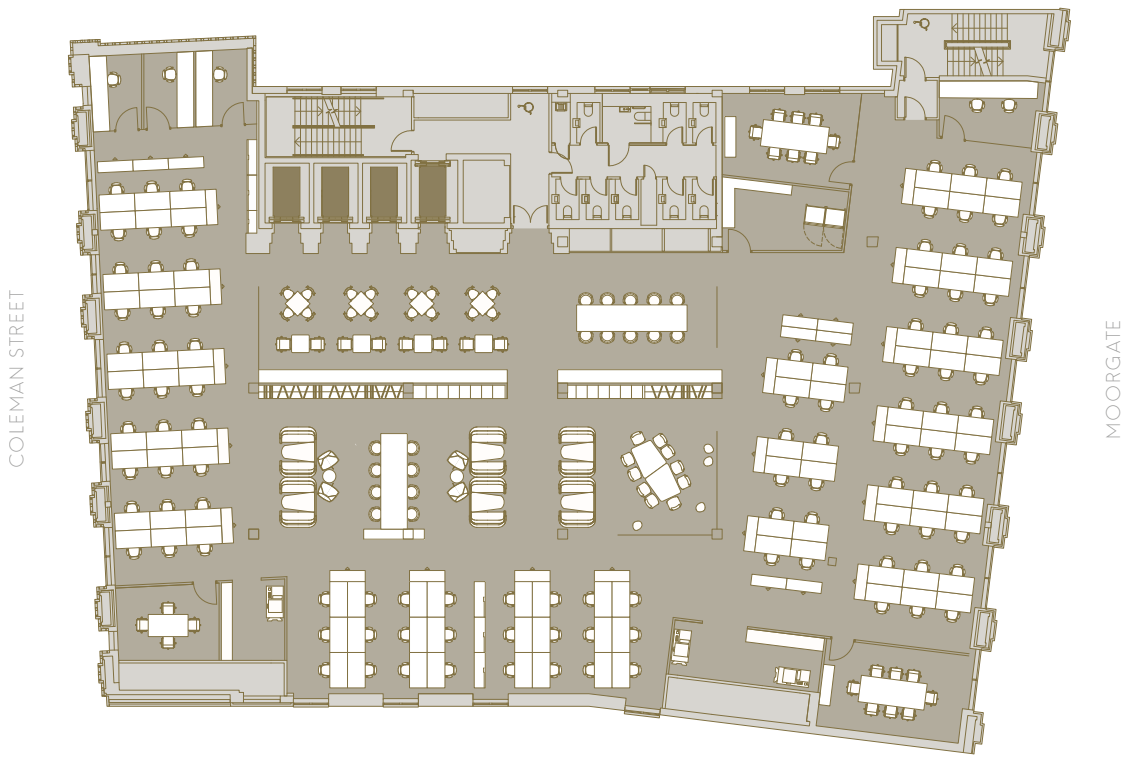

Floor plans not to scale, for indicative purposes only.  
 For typical floor plates, visit the website: [www.77coleman.com](http://www.77coleman.com)